

FAG

**6205**

Deep groove ball bearing

Schaeffler ID:  
0167198160000Deep groove ball bearing 62, single row,  
steel sheet metal cage

## Technical information

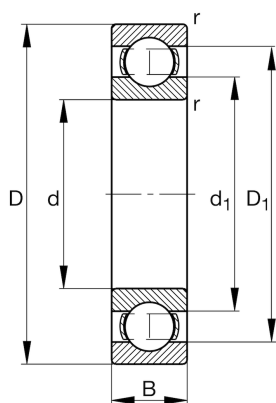
**Main Dimensions & Performance Data**

d	25 mm	Bore diameter
D	52 mm	Outside diameter
B	15 mm	Width
$C_r$	14,900 N	Basic dynamic load rating, radial
$C_{0r}$	7,800 N	Basic static load rating, radial
$C_{ur}$	530 N	Fatigue load limit, radial
$n_G$	19,600 1/min	Limiting speed
$n_{gr}$	14,400 1/min	Reference speed
	0.001 kg	Weight

**Dimensions**

$r_{min}$	1 mm	Minimum chamfer dimension
$D_1$	43.6 mm	Shoulder diameter outer ring
$d_1$	33.5 mm	Shoulder diameter inner ring

**Mounting dimensions**

$d_{a min}$	30.6 mm	Minimum diameter shaft shoulder
$D_{a max}$	46.4 mm	Maximum diameter of housing shoulder
$r_{a max}$	1 mm	Maximum fillet radius

**Calculation factors**

$f_0$	13.8	Calculation factor
-------	------	--------------------

**Temperature range**

$T_{min}$	-30 °C	Operating temperature min.
$T_{max}$	120 °C	Operating temperature max.